

STEP 5



5.1

Cobra GT 3.1 gas powered

Additional manual with Cobra GT 3.1 changes

In this additional manual you find the Cobra GT 3.1 changes explained. This is to be used as an addition to the Cobra GT 3.0 manual as on the same USB stick and / or website.

These pages explain the different steps compared to the 3.0 manual. Main differences are the shocktowers and shock mounting hardware, the shock brackets and the new brake system. The other steps are very similar or the same.

Below you find the new Cobra GT 3.1 spare part numbers.

- 600744 Brake disk (2) SRX8
- 600748 Brake plate spring (4) SRX8
- 600768 Shock mount alu hardcoated (2) SRX8
- 600769 Shock mount washer alu (4) SRX8
- 600829 Brake plate (4) SRX8
- 600980 Shocktower front carbon V3 811 GT
- 600981 Shocktower rear carbon V3 811 GT
- 600982 Shock extension bracket front V2 (2) 811 GT
- 600983 Shock extension bracket rear V2 (2) 811 GT
- 600984 Shock mount alu hardcoated long (2) GT
- 600988 Brake plate mount set (4) 811 GT 3.1

Enjoy building and racing the Cobra GT 3.1 racing car !

SPT – Serpent Performance Team

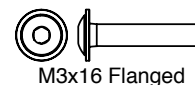
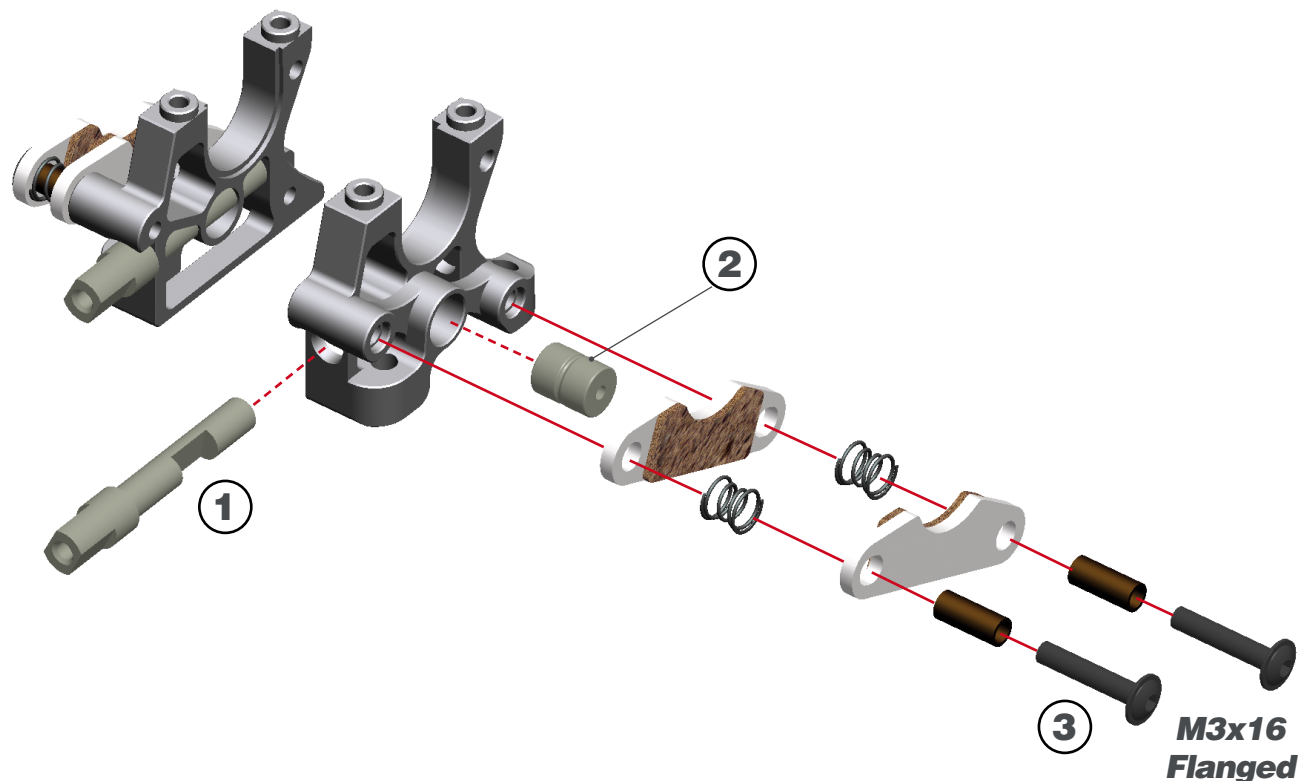

STEP 6

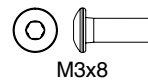
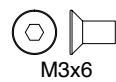
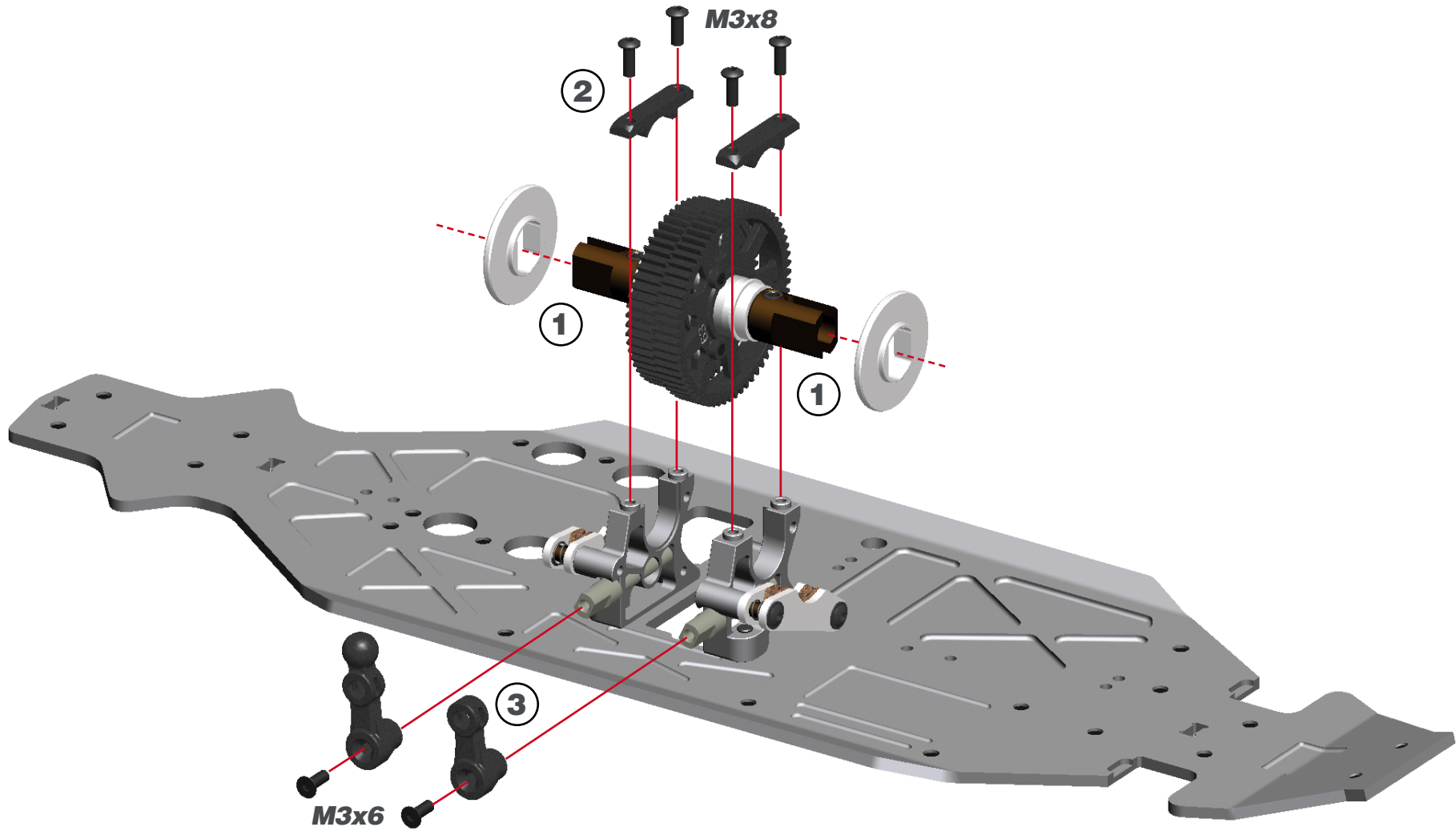

STEP 14

14.2

M3x14

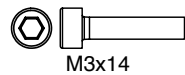
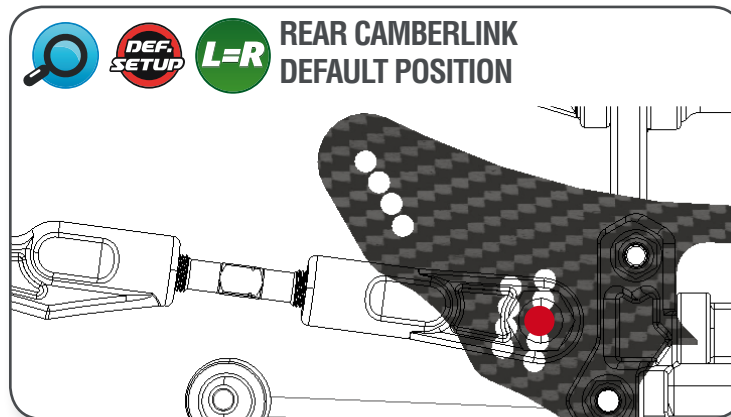
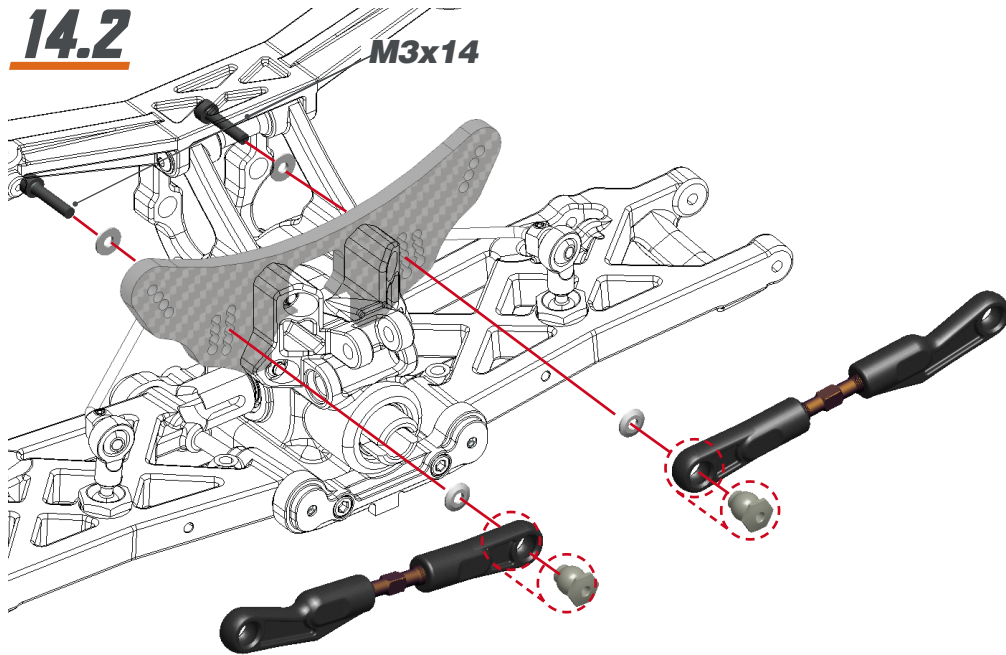

M3x14

STEP 23

23.2

M3x14

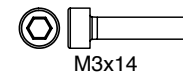
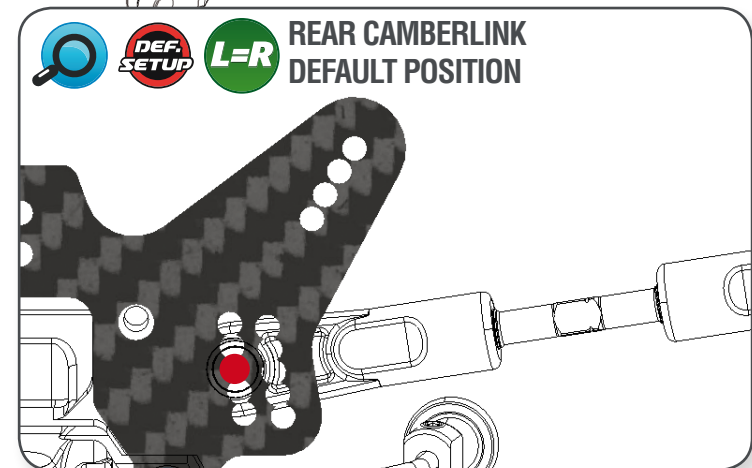
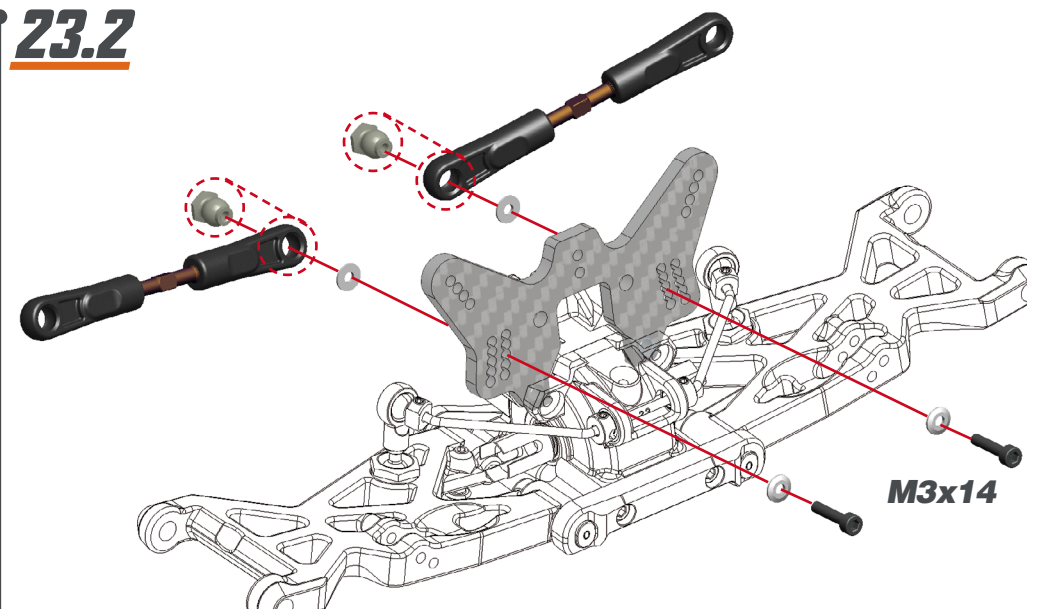

M3x14

STEP 45

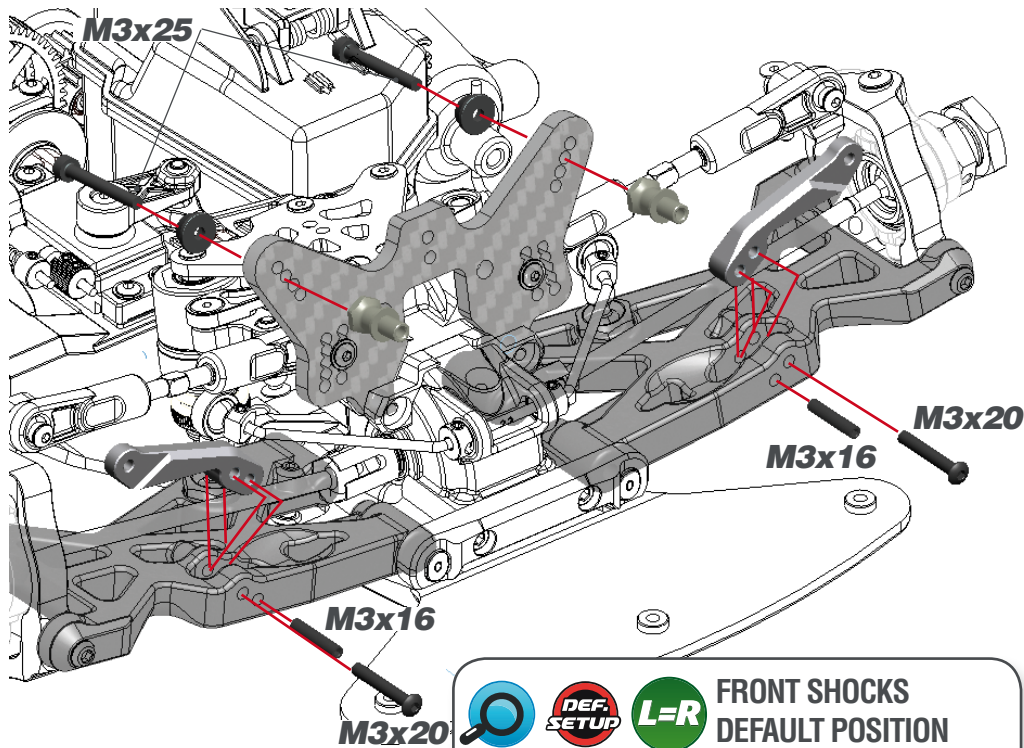

STEP 46

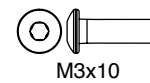
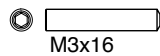
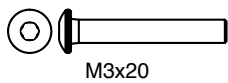
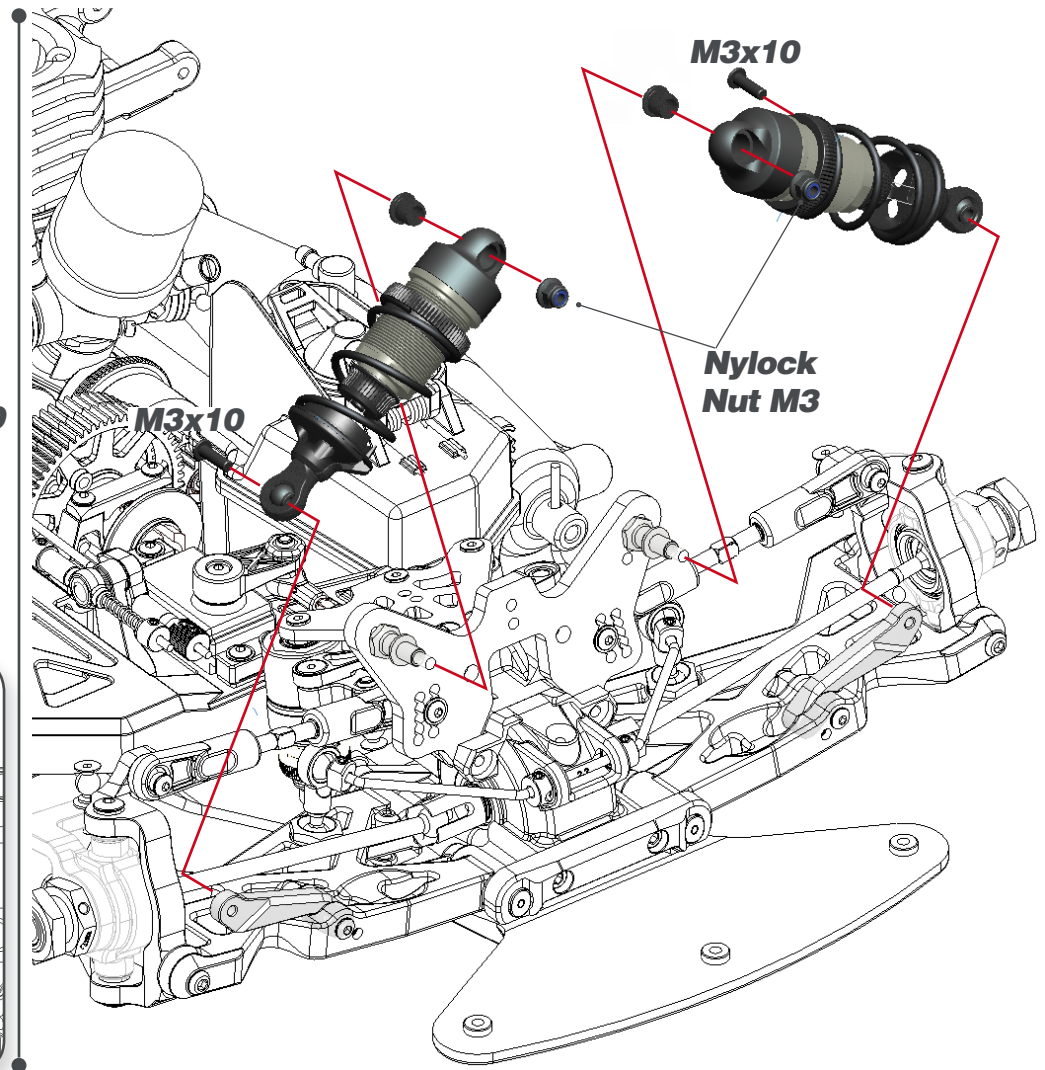

STEP 47

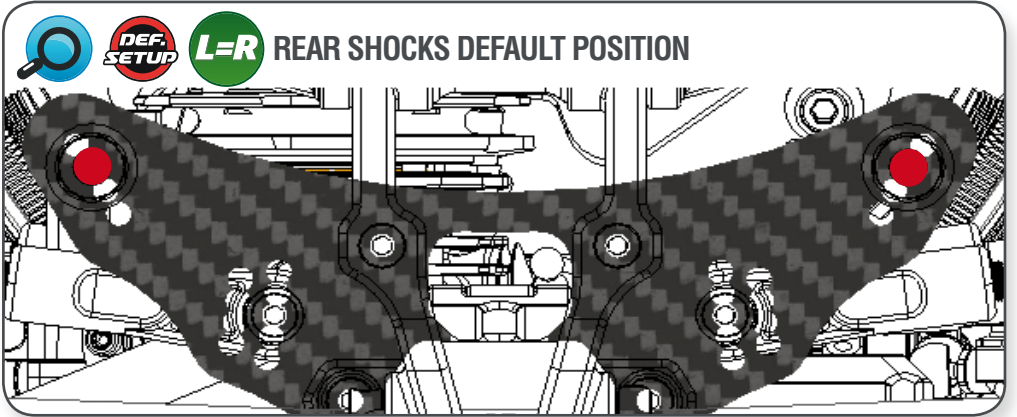
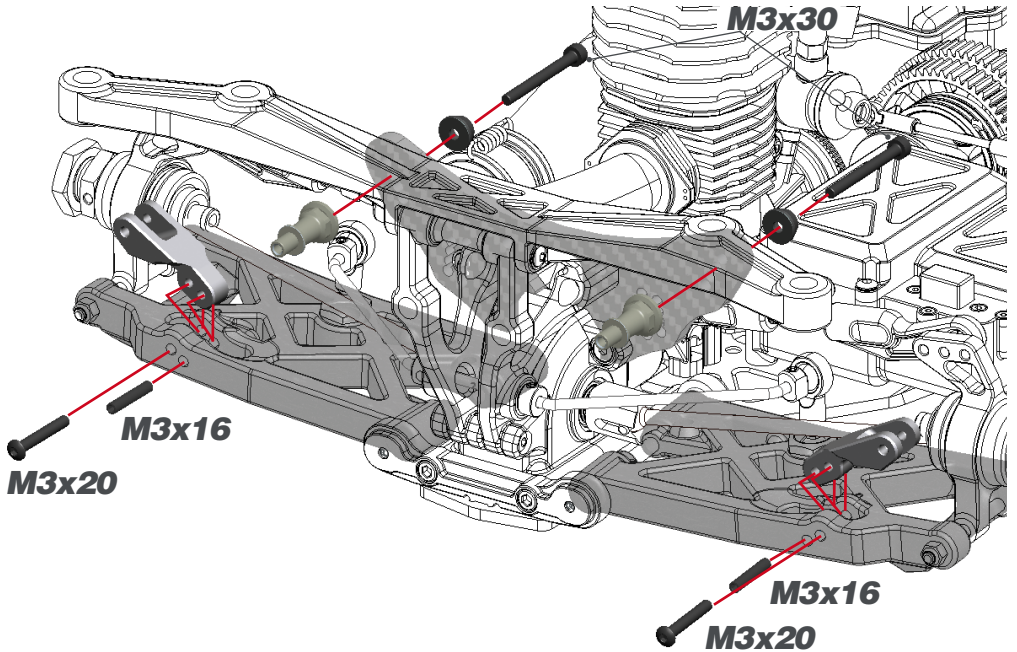

STEP 48

